



- Cast iron 3-jaw mandrel
- 2 steel shafts holding the mandrel, mounted on ball joint bearings on rollers set in the swivelling part of the base
- Connecting rod hydraulic expansion made of cast iron
- Steel lateral guides, held in position by screws; indexing handle for easy adjustment according to coil width
- Fixed part of the base made of rolled steel
- Turret mounted on bearing pivot
- Manual rotation of the turret to 180° and indexing through pneumatic cylinder
- Mandrel selection in the automatic mode via 2 electrical contacts
- Base made of rolled, welded steel
- Hydraulic generator and distributor integrated onto the turret

RANGE AND FEATURES

| Model | Max. load (kg) | Max. width without lateral guide (mm) | Max. width with lateral guides (mm) | Max. width with GLI2 (mm) | Expansion diameter (mm) | Max. outer diameter without wedge (mm) | Weight (kg) | Electrical power 400 V - 50 Hz (kVA) | | |
|-----------------|-------------------|--|--|---------------------------------|-------------------------------|---|----------------|--|-------------|-----|
| | | | | | | | | FPS | FPS - MO | VV |
| D 2381 D | 2 x 4500 | 680 | 520 | 520 | 460 to 530 | 1600 | 2400 | 1.8 | 2.5 | 4.5 |
| D 2381 F | 2 x 4500 | 980 | 820 | 820 | 460 to 530 | 1600 | 2900 | 1.8 | 2.5 | 4.5 |
| D 2381 G | 2 x 4500 | 1180 | 1020 | 1020 | 460 to 530 | 1600 | 3400 | 1.8 | 2.5 | 4.5 |
| D 2381 H | 2 x 4000 | 1320 | 1160 | 1300 | 460 to 530 | 1600 | 3900 | 1.8 | 2.5 | 4.5 |

DIMENSIONS

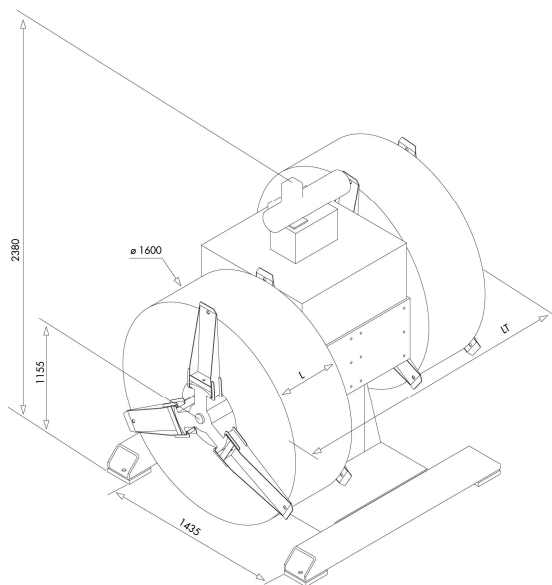

| Model | L | LT |
|-----------------|------|------|
| D 2381 D | 520 | 2370 |
| D 2381 F | 820 | 2970 |
| D 2381 G | 1020 | 3370 |
| D 2381 H | 1160 | 3610 |