

The L7155 3 in 1 line combines uncoiler with straightener-feeder. Both are assembled on a common base in welded steel to make easier the fitting and the connection.

→ **Uncoiler :**

- 3-jaw mandrel made of steel
- The mandrel is mounted on sealed ball bearing units
- Cast iron connecting rod expansion
- Steel lateral guides, held in position by screws for easy adjustment according to coil width
- AC motor with VV frequency variator (400 V – 50 Hz)
- Speed data adjustable by potentiometer
- Loop control with photo cells and restarting through an adjusting time out
- Safety pneumatic pressure arm fitted on the bottom of the uncoiler
- Overall arm width : 50 mm

→ **Straightener - feeder :**

- 7x50 mm diameter straightening rolls
- The 4 upper straightening rolls are mounted on a cradle
- Manual cradle depth and tilt adjustment through 2 independent screws
- 1 pair of 80 mm diameter outlet feeding rolls
- POR : sheet release for piloting through pneumatic opening of the feeding rolls and setting of motor torque to 0
- All straightening rolls are hardened (60Rck) and ground
- RCS : the feeding rolls are sandblasted and hard chrome plated (70Rck)
- Lower straightening and feeding rolls motorised through a cylindrical gear pair
- Motorisation through one brushless motor with the **ECODRIVE 2 numerical control** and precision gear box
- Crocodile opening of the head by lever, for safe and easy roll cleaning, and easy strip insertion
- Manual height adjustment by hydraulic jack +/- 100 mm with 2 height of pass-line
- Inlet strip guide made of 2 independent discs, manually adjustable
- Bearing lubrication for life



RANGE AND FEATURES

Model	Max . load (kg)	Coil max width with guides (mm)	Expansion diameter (mm)	Max. outer diameter (mm)	Thickness			Straightening rolls		Feeding rolls		Pass -Line height (mm)	Wei ght (kg)	Power (kVA)
					Min.	Max.	Max*	Qty	Ø (mm)	Qty	Ø (mm)			
L7155 B	300 0	300	390 to 525	1400	0.3	4.1	2.0	7	50	2	80	910 to 1110 1110 to 1310	157 0	5.5
L7155 D	300 0	500	390 to 528	1400	0.3	4.0	1.8	7	50	2	80	910 to 1110 1110 to 1310	170 0	5.5

Straightening capacities are given for a yield point Re = 300 N/mm² and a tensile strength Rm = 400 N/mm². * Max. thickness for max. width

DIMENSIONS

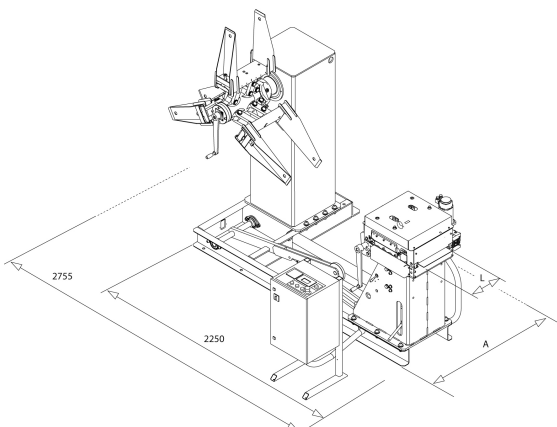

Model	L	A
L7155 B	300	1350
L7155 D	500	1460